

# SLIM GRIPPER

## G100S & G130S - series

## Feature

- Can be applied to various applications by installing on robots.
- With slim thickness makes it easy to work in a narrow space.
- Handling of products from different mounting positions
- Integrated Smart Efficiency Valve (Smart EV).

\* G130S/ height before gripper object: 26.5mm / after gripping (H) : 17.5mm

G100S/ height before gripper object: 27.5mm / after gripping (H) : 18.5mm

### • Example of use (Application)

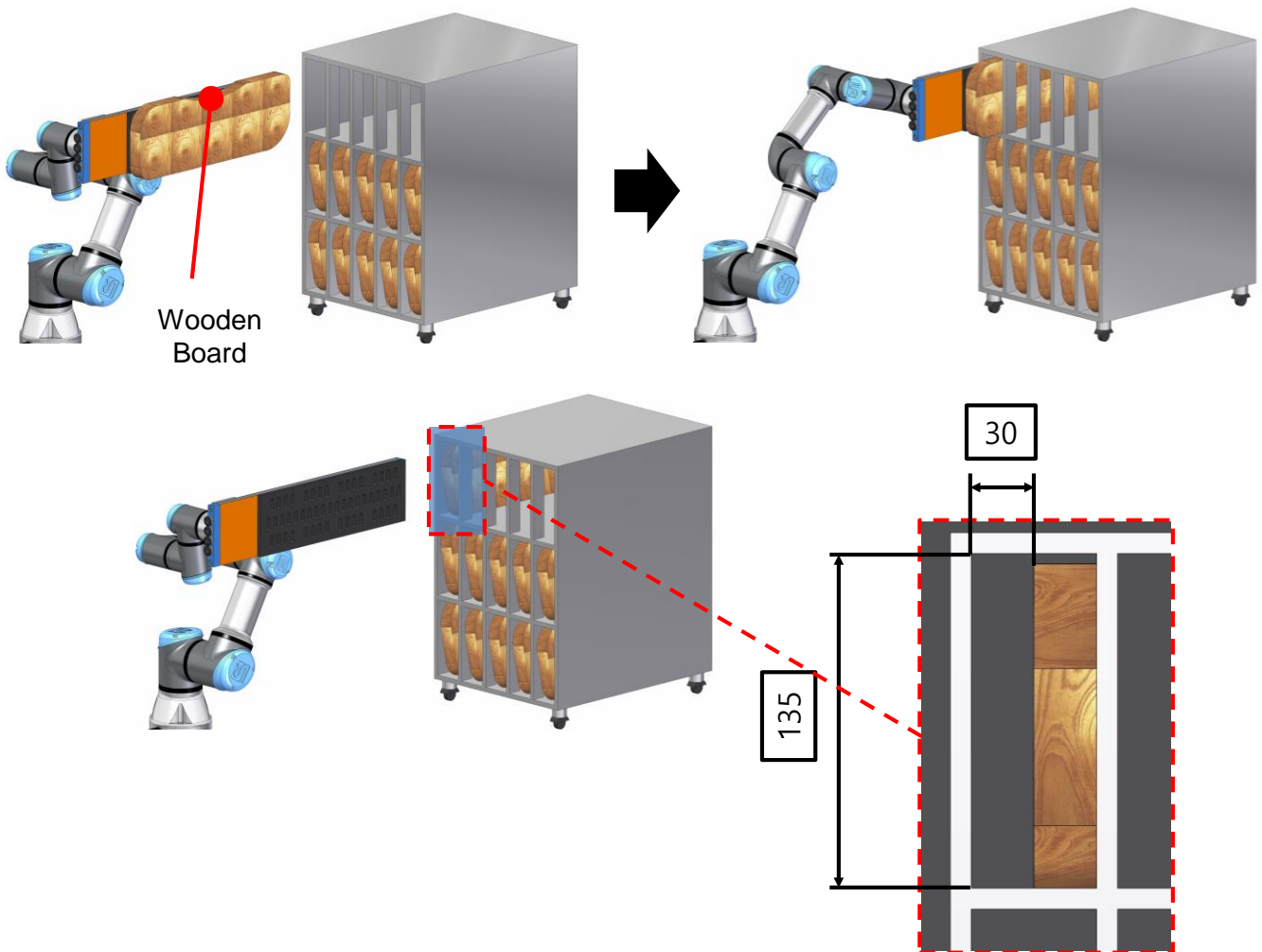

**Feature**

- **Cartridge Type**  
(with vacuum cartridge)

Mounting Position

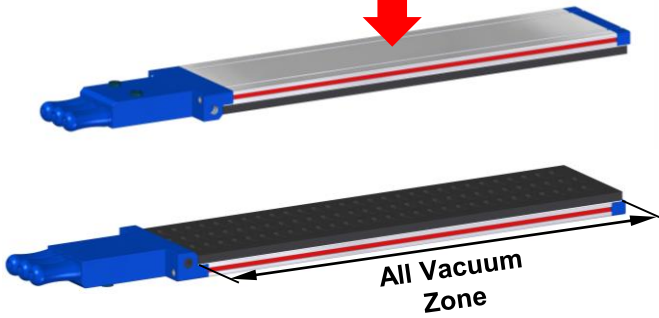

**G130S X ( ) – C3 - ELC**

- **Flange Type**  
(without vacuum cartridge)

Mounting Position

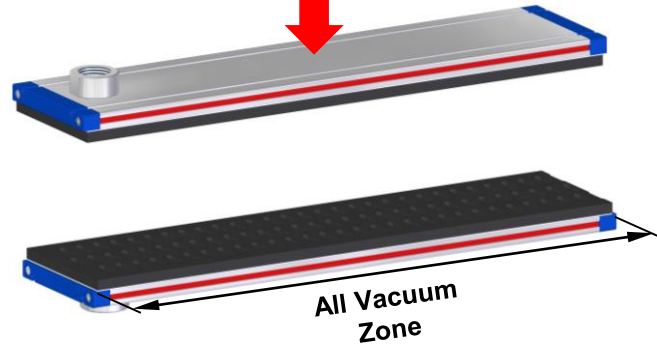

**G130S X ( ) – F - ELC**

- **Cartridge Type + Passive Zone**  
(with vacuum cartridge)

Mounting Position

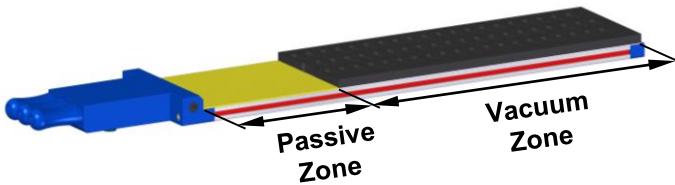

**G130S X ( ) – C3 – Z - ELC**

- **Flange Type + Passive Zone**  
(without vacuum cartridge)

Mounting Position

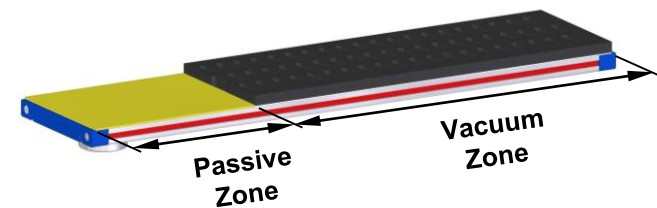

**G130S X ( ) – F – Z - ELC**

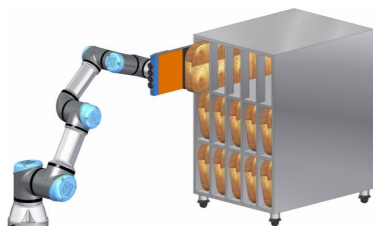

- **Passive Zone:** when transferring an object to the narrow space as shown in the figure (◀), a flanged-on area (position of the mount) is biased to one side of the gripper. There will be no vacuum suction.

**Specification**
**G100S Series**

Description	G100SX310-C2-ELC	G100SX510-C2-ELC
Max. Vacuum Level	- 80 kPa	
Open Vacuum Flow	342 l/min	
Max Feed Pressure	7 bar	
Temperature	-20 ~ 80 °C	
Material	Al, EPDM, NBR, PPS, POM	
Weight	2 kg	2.5 kg

**G130S Series**

Description	G130SX550 -C3-ELC	G130SX650 -C3-ELC	G130SX750 -C3-ELC	G130SX850 -C3-ELC	G130SX1000 -C3-ELC
Max. Vacuum Level	- 80 kPa				
Open Vacuum Flow	1,023 l/min				
Max Feed Pressure	7 bar				
Temperature	-20 ~ 80 °C				
Material	Al, EPDM, NBR, PPS, POM				
Weight	3.2 kg	3.5 kg	3.9 kg	4.3 kg	4.8 kg

Description	Supply Air pressure	Air Consumption
G100SX310-C3-ELC	4 bar	304 l/min
G100SX510-C3-ELC		
G130SX550-C3-ELC	4 bar	456 l/m
G130SX650-C3-ELC		
G130SX750-C3-ELC		
G130SX850-C3-ELC		
G130SX1000-C3-ELC		

 **Specification**

Model	Holding force at 40% Sealing (Kgf)	Holding force at 60% Sealing (Kgf)	Holding force at 80% Sealing (Kgf)	Holding force at 100% Sealing (Kgf)
<b>G100SX310-C3-ELC</b>	31.5	50.4	69.3	88.1
<b>G100SX510-C3-ELC</b>	56.7	88.1	119.6	151.1

Model	Holding force at 40% Sealing (Kgf)	Holding force at 60% Sealing (Kgf)	Holding force at 80% Sealing (Kgf)	Holding force at 100% Sealing (Kgf)
<b>G100SX310-C3-Z-ELC</b>	12.6	25.2	31.5	44.1
<b>G100SX510-C3-Z-ELC</b>	37.8	63	81.8	107

Model	Holding force at 40% Sealing (Kgf)	Holding force at 60% Sealing (Kgf)	Holding force at 80% Sealing (Kgf)	Holding force at 100% Sealing (Kgf)
<b>G130SX550-C3-ELC</b>	84	130	167.9	213.7
<b>G130SX650-C3-ELC</b>	99.2	152.7	206.1	259.5
<b>G130SX750-C3-ELC</b>	122.1	183.2	244.2	305.3
<b>G130SX850-C3-ELC</b>	137.4	206.1	274.8	353.5
<b>G130SX1000-C3-ELC</b>	160.3	244.2	320.6	404.5

Model	Holding force at 40% Sealing (Kgf)	Holding force at 60% Sealing (Kgf)	Holding force at 80% Sealing (Kgf)	Holding force at 100% Sealing (Kgf)
<b>G130SX550-C3-Z-ELC</b>	53.4	84	114.5	145
<b>G130SX650-C3-Z-ELC</b>	76.3	114.5	152.7	190.8
<b>G130SX750-C3-Z-ELC</b>	91.6	137.4	183.2	229
<b>G130SX850-C3-Z-ELC</b>	106.9	160.3	213.7	274.8
<b>G130SX1000-C3-Z-ELC</b>	130	198.4	267.1	335.8

\*\* Differences may occur depending on the surface or porous of the handling material, so please use this as a reference data only. The tested (measured) values were taken at the center of each gripper unit, so the lifting force may vary depending on the actual usage method.

**Dimensions**

**G100S Series**

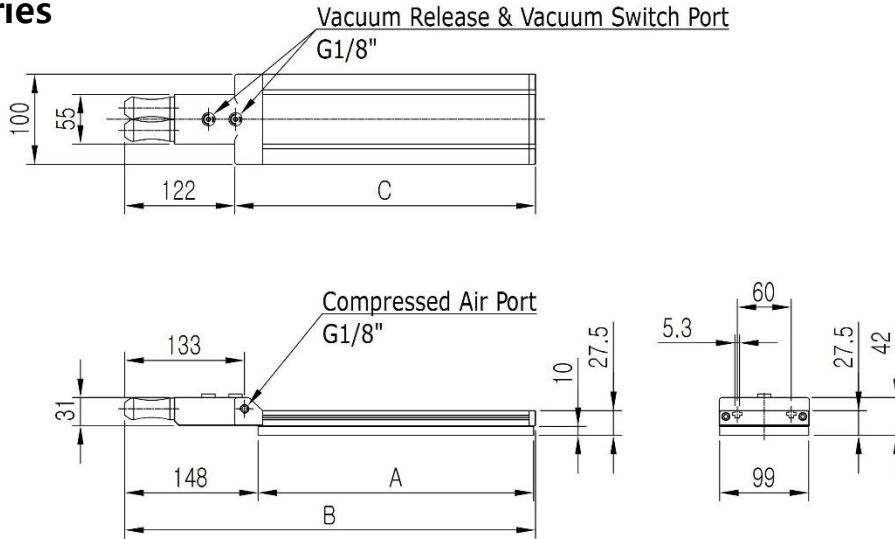

Model	A	B	C
G100SX310-C2-ELC	310	506	341
G100SX510-C2-ELC	510	706	541

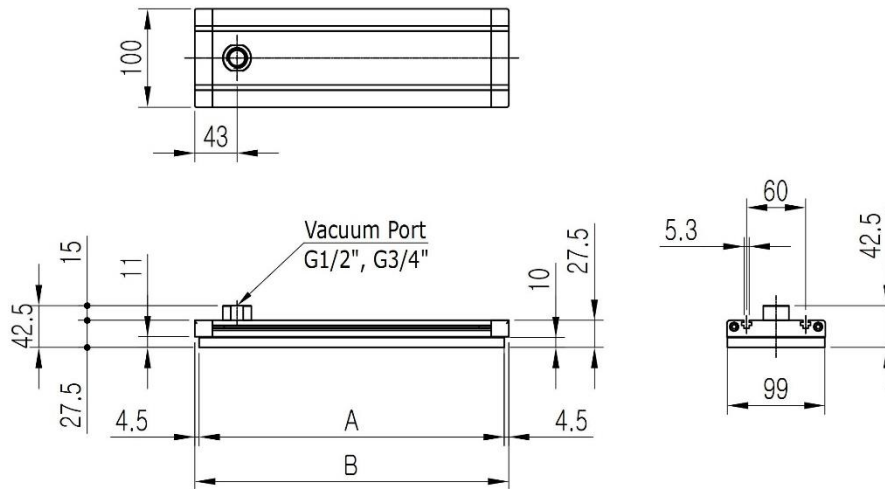

Model	A	B
G100SX310-F-ELC	310	319
G100SX510-F-ELC	510	519

**Dimensions**

**G100S Series**

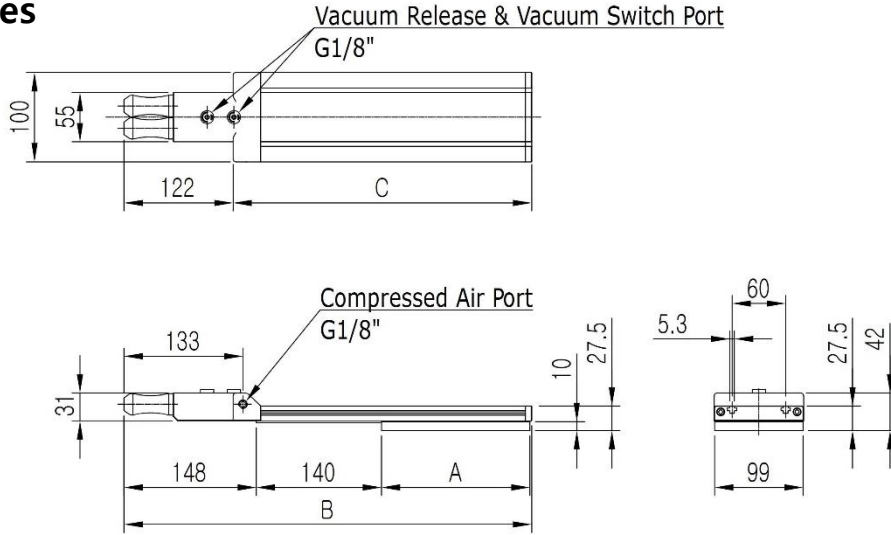

Model	A	B	C
G100SX310-C2-Z-ELC	160	506	341
G100SX510-C2-Z-ELC	360	706	541

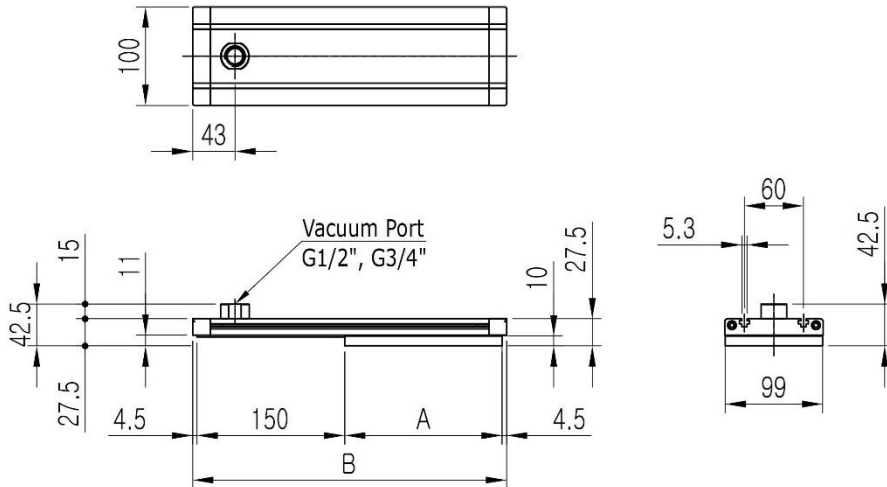

Model	A	B
G100SX310-F-Z-ELC	160	319
G100SX510-F-Z-ELC	360	519

**Dimensions**

**G130S Series**

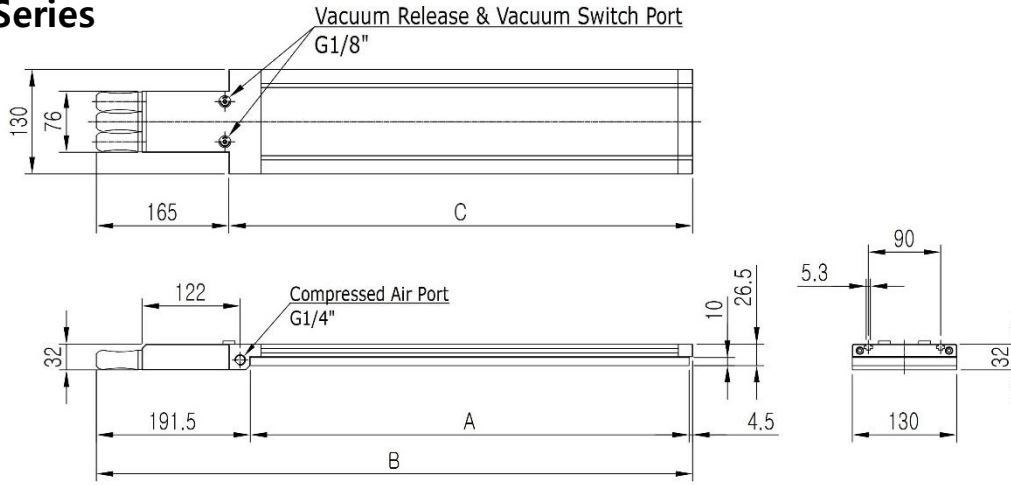

Model	A	B	C
G130SX550-C3-ELC	546	742	577
G130SX650-C3-ELC	646	842	677
G130SX750-C3-ELC	746	942	777
G130SX850-C3-ELC	846	1042	877
G130SX1000-C3-ELC	994	1190	1025

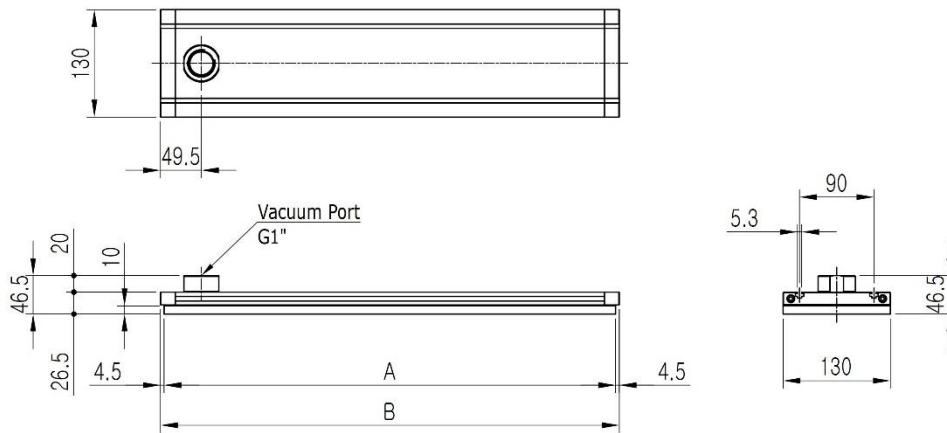

Model	A	B
G130SX550-F-ELC	546	555
G130SX650-F-ELC	646	655
G130SX750-F-ELC	746	755
G130SX850-F-ELC	846	855
G130SX1000-F-ELC	994	1003

**Dimensions**

**G130S Series**

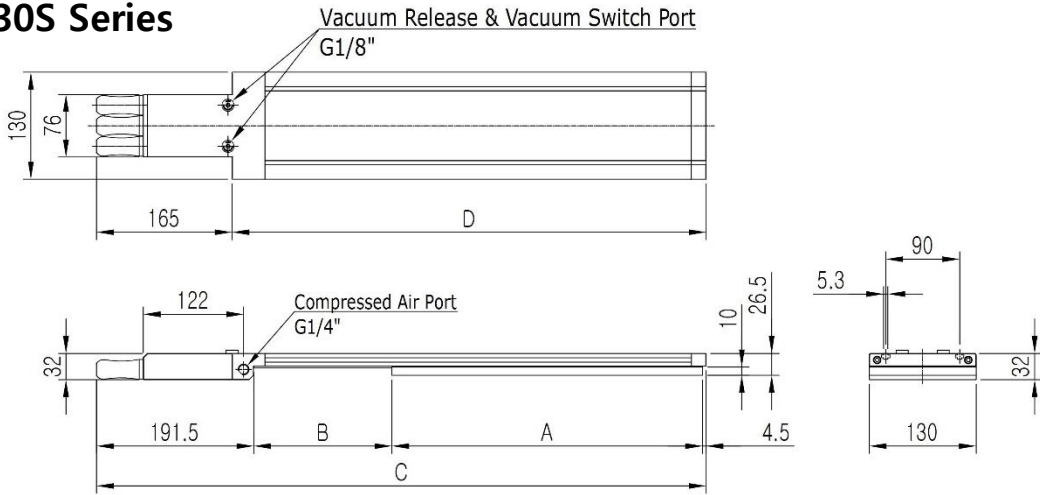

Model	A	B	C	D
G130SX550-C3-Z-ELC	376	170	742	577
G130SX650-C3-Z-ELC	476		842	677
G130SX750-C3-Z-ELC	576		942	777
G130SX850-C3-Z-ELC	676		1042	877
G130SX1000-C3-Z-ELC	824		1190	1025

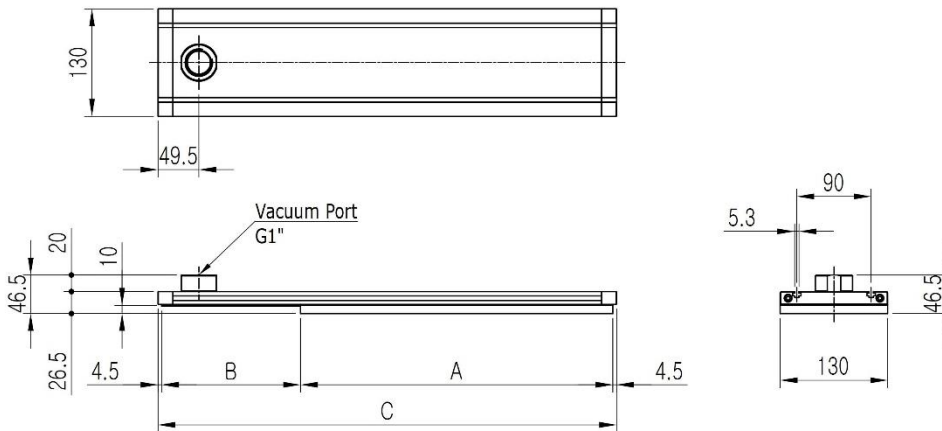

Model	A	B	C
G130SX550-F-Z-ELC	376	170	555
G130SX65.0-F-Z-ELC	476		655
G130SX750-F-Z-ELC	576		755
G130SX850-F-Z-ELC	676		855
G130SX1000-F-Z-ELC	824		1003

**Ordering No.**

**G100S Series**

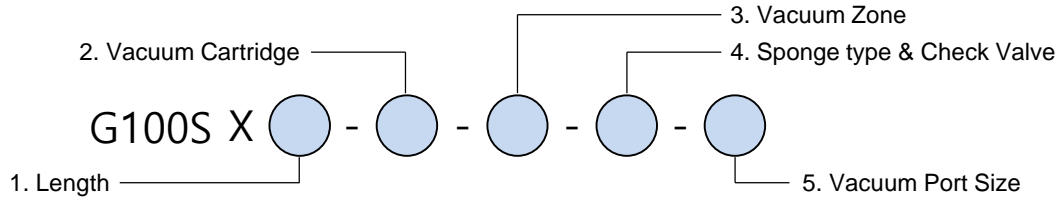

1. Length	Description	Symbol
	Length 310mm	<b>310</b>
	Length 510mm	<b>510</b>
2. Vacuum Cartridge	Description	Symbol
	Vacuum Cartridge, VC302 X 2EA	<b>C2</b>
	No Vacuum Cartridge, Flange	<b>F</b>
3. Vacuum Zone	Description	Symbol
	All Vacuum Zone(V-Grip Type)	<b>Blank</b>
	All Vacuum Zone + Passive Zone(Slim Gripper Type)	<b>Z</b>
4. Sponge type & Check Valve	Description	Symbol
	Oval shape suction hole, Smart Efficiency Valve type	<b>ELC</b>
5. Vacuum Port Size	Description	Symbol
	G 1/2" Female	<b>G12</b>
	G 3/4" Female	<b>G34</b>
	<ul style="list-style-type: none"> <li>This option (vacuum port size) is only available with "F" flange type (No vacuum cartridge model)</li> </ul>	

**Ordering No.**

**G130S Series**

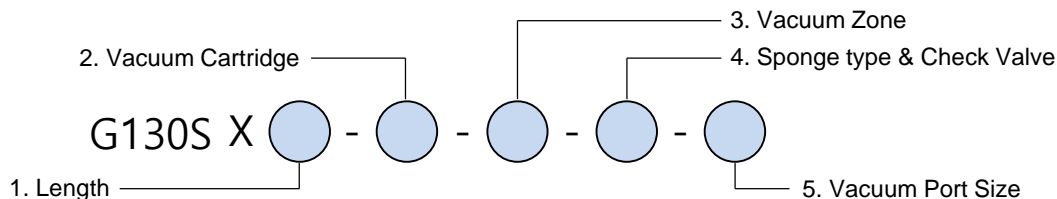

1. Length	Description	Symbol
	Length 550mm	<b>550</b>
	Length 650mm	<b>650</b>
	Length 750mm	<b>750</b>
	Length 850mm	<b>850</b>
	Length 1000mm	<b>1000</b>
2. Vacuum Cartridge	Description	Symbol
	Vacuum Cartridge, VC303 X 3EA	<b>C3</b>
	No Vacuum Cartridge, Flange	<b>F</b>
3. Vacuum Zone	Description	Symbol
	All Vacuum Zone(V-Grip Type)	<b>Blank</b>
	All Vacuum Zone + Passive Zone(Slim Gripper Type)	<b>Z</b>
4. Sponge type & Check Valve	Description	Symbol
	Oval shape suction hole, Smart Efficiency Valve type	<b>ELC</b>
5. Vacuum Port Size	Description	Symbol
	G 1" Female	<b>G01</b>
	<ul style="list-style-type: none"> <li>This option (vacuum port size) is only available with "F" flange type (No vacuum cartridge model)</li> </ul>	