

SUCTION CUPS / Flat & Curve

VFC50



Features and Strengths

Specifically designed for flat and curved surface
Available to handle multiple objects with the same suction cup

Examples of use

Automobile Windscreens, Roof and Door, Metal Sheet
Shaped Metal panel, TV cathode ray tube



Recommended Lifting Force (Max.)

Model	Volume (cm ³)	Lifting Force (Kg) - Perpendicular			Lifting Force (Kg) - Parallel		
		- 20 kPa	- 60 kPa	- 90 kPa	- 20 kPa	- 60 kPa	- 90 kPa
VFC50	10.00	2.85	6.94	10.20	2.61	6.34	8.20

※ The lifting force above does not include safety factor

Material Specifications

Material	Hardness Shore (°)	Color	Temperature (°C)
NBR	60	Black	-20~110
Silicone	55	Red	-70~200
White Silicone	55	Translucent White	-70~200
White Silicone (FDA)	55	Translucent White	-70~200
High temp. Silicone	50	Blue	-70~280
Conductive Silicone	70	Smoky Black	-45~90
Urethane	60	Dark Green	0~100
Mark Free	75	Black	-10~100
Polyurethane	60	Translucent Orange	0~60

Material Resistance

Description	NBR	Silicone	White Silicone	High temp. Silicone	Conductive Silicone	Urethane	Mark Free	Polyurethane
Wear Resistance	Excellent	Good	Good	Good	Good	Excellent	Good	Excellent
Oil	Excellent	Poor	Poor	Poor	Poor	Excellent	Excellent	Excellent
Weather / Ozone	Fair	Excellent	Excellent	Excellent	Excellent	Excellent	Excellent	Excellent
Alcohol	Good	Good	Good	Good	Good	Fair	Good	Fair
Acid	Fair	Poor	Poor	Poor	Poor	Poor	Excellent	Fair

Dimension

[Unit : mm]

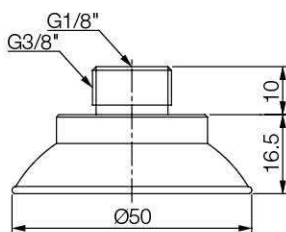

[With 1838MF fitting]

I Build an Ordering No.



: Pre-mounted fitting

1. Suction cup	Description	Weight (g)	Symbol
	Flat-Curved suction cup, 50mm diameter, Nitrile (NBR), G1/8 female - G3/8 male	16.42	VFC50-N-1838MF
	Flat-Curved suction cup, 50mm diameter, Silicone, G1/8 female - G3/8 male	15.62	VFC50-S-1838MF
	Flat-Curved suction cup, 50mm diameter, White silicone, G1/8 female - G3/8 male	15.95	VFC50-WS-1838MF
	Flat-Curved suction cup, 50mm diameter, White silicone (FDA), G1/8 female - G3/8 male	15.95	VFC50-WS-1838MF (FDA)
	Flat-Curved suction cup, 50mm diameter, High temperature silicone, G1/8 female - G3/8 male	16.98	VFC50-HS-1838MF
	Flat-Curved suction cup, 50mm diameter, Conductive silicone , G1/8 female - G3/8 male	16.26	VFC50-CS-1838MF
	Flat-Curved suction cup, 50mm diameter, Urethane, G1/8 female - G3/8 male	17.01	VFC50-U-1838MF
	Flat-Curved suction cup, 50mm diameter, Mark free, G1/8 female - G3/8 male	17.74	VFC50-A-1838MF
	Flat-Curved suction cup, 50mm diameter, Polyurethane, G1/8 female - G3/8 male	14.99	VFC50-PU-1838MF

SUCTION CUPS / Flat & Curve

VFC60



Features and Strengths

Specifically designed for flat and curved surface
Available to handle multiple objects with the same suction cup

Examples of use

Automobile Windscreens, Roof and Door, Metal Sheet
Shaped Metal panel, TV cathode ray tube



Recommended Lifting Force (Max.)

Model	Volume (cm ³)	Lifting Force (Kg) - Perpendicular			Lifting Force (Kg) - Parallel		
		- 20 kPa	- 60 kPa	- 90 kPa	- 20 kPa	- 60 kPa	- 90 kPa
VFC60	20.00	4.55	11.57	15.30	3.05	7.92	10.70

※ The lifting force above does not include safety factor

Material Specifications

Material	Hardness Shore (°)	Color	Temperature (°C)
NBR	60	Black	-20~110
Silicone	55	Red	-70~200
White Silicone	55	Translucent White	-70~200
White Silicone (FDA)	55	Translucent White	-70~200
High temp. Silicone	50	Blue	-70~280
Conductive Silicone	70	Smoky Black	-45~90
Urethane	60	Dark Green	0~100
Mark Free	75	Black	-10~100
Polyurethane	60	Translucent Orange	0~60

Material Resistance

Description	NBR	Silicone	White Silicone	High temp. Silicone	Conductive Silicone	Urethane	Mark Free	Polyurethane
Wear Resistance	Excellent	Good	Good	Good	Good	Excellent	Good	Excellent
Oil	Excellent	Poor	Poor	Poor	Poor	Excellent	Excellent	Excellent
Weather / Ozone	Fair	Excellent	Excellent	Excellent	Excellent	Excellent	Excellent	Excellent
Alcohol	Good	Good	Good	Good	Good	Fair	Good	Fair
Acid	Fair	Poor	Poor	Poor	Poor	Poor	Excellent	Fair

Dimension

[Unit : mm]

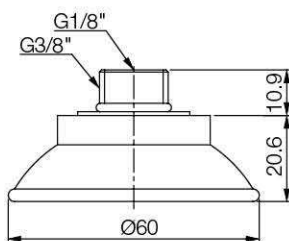

[With 1838MF fitting]

I Build an Ordering No.



: Pre-mounted fitting

1. Suction cup	Description	Weight(g)	Symbol
	Flat-Curved suction cup, 60mm diameter, Nitrile (NBR), G1/8 female - G3/8 male	31.32	VFC60-N-1838MF
	Flat-Curved suction cup, 60mm diameter, Silicone, G1/8 female - G3/8 male	30.14	VFC60-S-1838MF
	Flat-Curved suction cup, 60mm diameter, White silicone, G1/8 female - G3/8 male	30.48	VFC60-WS-1838MF
	Flat-Curved suction cup, 60mm diameter, White silicone (FDA), G1/8 female - G3/8 male	30.48	VFC60-WS-1838MF (FDA)
	Flat-Curved suction cup, 60mm diameter, High temperature silicone, G1/8 female - G3/8 male	33.14	VFC60-HS-1838MF
	Flat-Curved suction cup, 60mm diameter, Conductive silicone , G1/8 female - G3/8 male	31.02	VFC60-CS-1838MF
	Flat-Curved suction cup, 60mm diameter, Urethane, G1/8 female - G3/8 male	32.46	VFC60-U-1838MF
	Flat-Curved suction cup, 60mm diameter, Mark free, G1/8 female - G3/8 male	35.67	VFC60-A-1838MF
	Flat-Curved suction cup, 60mm diameter, Polyurethane, G1/8 female - G3/8 male	26.47	VFC60-PU-1838MF

SUCTION CUPS / Flat & Curve

VFC60x1



Features and Strengths

Specifically designed for flat and curved surface
Available to handle multiple objects with the same suction cup

Examples of use

Automobile Windscreens, Roof and Door, Metal Sheet
Shaped Metal panel, TV cathode ray tube



Recommended Lifting Force (Max.)

Model	Volume (cm ³)	Lifting Force (Kg) - Perpendicular			Lifting Force (Kg) - Parallel		
		- 20 kPa	- 60 kPa	- 90 kPa	- 20 kPa	- 60 kPa	- 90 kPa
VFC60x1	20.00	4.55	11.57	15.30	3.05	7.92	10.70

※ The lifting force above does not include safety factor

Material Specifications

Material	Hardness Shore (°)	Color	Temperature (°C)
NBR	60	Black	-20~110
Silicone	55	Red	-70~200
White Silicone	55	Translucent White	-70~200
White Silicone (FDA)	55	Translucent White	-70~200
High temp. Silicone	50	Blue	-70~280
Conductive Silicone	70	Smoky Black	-45~90
Urethane	60	Dark Green	0~100
Mark Free	75	Black	-10~100
Polyurethane	60	Translucent Orange	0~60

Material Resistance

Description	NBR	Silicone	White Silicone	High temp. Silicone	Conductive Silicone	Urethane	Mark Free	Polyurethane
Wear Resistance	Excellent	Good	Good	Good	Good	Excellent	Good	Excellent
Oil	Excellent	Poor	Poor	Poor	Poor	Excellent	Excellent	Excellent
Weather / Ozone	Fair	Excellent	Excellent	Excellent	Excellent	Excellent	Excellent	Excellent
Alcohol	Good	Good	Good	Good	Good	Fair	Good	Fair
Acid	Fair	Poor	Poor	Poor	Poor	Poor	Excellent	Fair

Dimension

[Unit : mm]

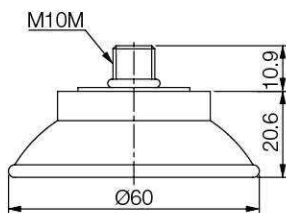

[With M10M fitting]

I Build an Ordering No.

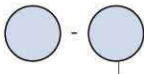
VFC60x1 -  : Pre-mounted fitting
 1. Suction Cup

1. Suction cup	Description	Weight(g)	Symbol
	Flat-Curved suction cup, 60mm diameter, Nitrile (NBR), M10xP1.5 Male Fitting	29.44	VFC60X1-N-M10M
	Flat-Curved suction cup, 60mm diameter, Silicone, M10xP1.5 Male Fitting	28.33	VFC60x1-S-M10M
	Flat-Curved suction cup, 60mm diameter, White silicone, M10xP1.5 Male Fitting	28.65	VFC60x1-WS-M10M
	Flat-Curved suction cup, 60mm diameter, White silicone (FDA), M10xP1.5 Male Fitting	28.65	VFC60x1-WS-M10M (FDA)
	Flat-Curved suction cup, 60mm diameter, High temperature silicone, M10xP1.5 Male Fitting	31.15	VFC60x1-HS-M10M
	Flat-Curved suction cup, 60mm diameter, Conductive silicone , M10xP1.5 Male Fitting	29.15	VFC60x1-CS-M10M
	Flat-Curved suction cup, 60mm diameter, Urethane, M10xP1.5 Male Fitting	30.51	VFC60x1-U-M10M
	Flat-Curved suction cup, 60mm diameter, Mark free, M10xP1.5 Male Fitting	33.52	VFC60x1-A-M10M
	Flat-Curved suction cup, 60mm diameter, Polyurethane, M10xP1.5 Male Fitting	24.88	VFC60x1-PU-M10M

SUCTION CUPS / Flat & Curve

VFC75



Features and Strengths

Specifically designed for flat and curved surface
Available to handle multiple objects with the same suction cup

Examples of use

Automobile Windscreens, Roof and Door, Metal Sheet
Shaped Metal panel, TV cathode ray tube

Recommended Lifting Force (Max.)

Model	Volume (cm ³)	Lifting Force (Kg) - Perpendicular			Lifting Force (Kg) - Parallel		
		- 20 kPa	- 60 kPa	- 90 kPa	- 20 kPa	- 60 kPa	- 90 kPa
VFC75	30.00	7.65	19.38	25.51	6.19	15.46	20.90

※ The lifting force above does not include safety factor

Material Specifications

Material	Hardness Shore (°)	Color	Temperature (°C)
NBR	60	Black	-20~110
Silicone	55	Red	-70~200
White Silicone	55	Translucent White	-70~200
White Silicone (FDA)	55	Translucent White	-70~200
High temp. Silicone	50	Blue	-70~280
Conductive Silicone	70	Smoky Black	-45~90
Urethane	60	Dark Green	0~100
Mark Free	75	Black	-10~100
Polyurethane	60	Translucent Orange	0~60

Material Resistance

Description	NBR	Silicone	White Silicone	High temp. Silicone	Conductive Silicone	Urethane	Mark Free	Polyurethane
Wear Resistance	Excellent	Good	Good	Good	Good	Excellent	Good	Excellent
Oil	Excellent	Poor	Poor	Poor	Poor	Excellent	Excellent	Excellent
Weather / Ozone	Fair	Excellent	Excellent	Excellent	Excellent	Excellent	Excellent	Excellent
Alcohol	Good	Good	Good	Good	Good	Fair	Good	Fair
Acid	Fair	Poor	Poor	Poor	Poor	Poor	Excellent	Fair

Dimension

[Unit : mm]

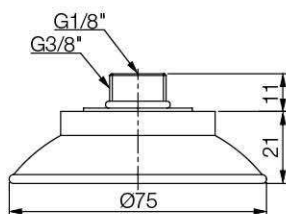

[With 1838MF fitting]

I Build an Ordering No.

VFC75 -  - 
1. Suction Cup

: Pre-mounted fitting

1. Suction cup	Description	Weight(g)	Symbol
	Flat-Curved suction cup, 75mm diameter, Nitrile (NBR), G1/8 female - G3/8 male	41.12	VFC75-N-1838MF
	Flat-Curved suction cup, 75mm diameter, Silicone, G1/8 female - G3/8 male	39.73	VFC75-S-1838MF
	Flat-Curved suction cup, 75mm diameter, White silicone, G1/8 female - G3/8 male	40.01	VFC75-WS-1838MF
	Flat-Curved suction cup, 75mm diameter, White silicone (FDA), G1/8 female - G3/8 male	40.01	VFC75-WS-1838MF (FDA)
	Flat-Curved suction cup, 75mm diameter, High temperature silicone, G1/8 female - G3/8 male	43.5	VFC75-HS-1838MF
	Flat-Curved suction cup, 75mm diameter, Conductive silicone , G1/8 female - G3/8 male	40.72	VFC75-CS-1838MF
	Flat-Curved suction cup, 75mm diameter, Urethane, G1/8 female - G3/8 male	43.79	VFC75-U-1838MF
	Flat-Curved suction cup, 75mm diameter, Mark free, G1/8 female - G3/8 male	47.13	VFC75-A-1838MF
	Flat-Curved suction cup, 75mm diameter, Polyurethane, G1/8 female - G3/8 male	39.86	VFC75-PU-1838MF

SUCTION CUPS / Flat & Curve

VFC75x1



Features and Strengths

Specifically designed for flat and curved surface
Available to handle multiple objects with the same suction cup

Examples of use

Automobile Windscreens, Roof and Door, Metal Sheet
Shaped Metal panel, TV cathode ray tube



Recommended Lifting Force (Max.)

Model	Volume (cm ³)	Lifting Force (Kg) - Perpendicular			Lifting Force (Kg) - Parallel		
		- 20 kPa	- 60 kPa	- 90 kPa	- 20 kPa	- 60 kPa	- 90 kPa
VFC75x1	30.00	7.65	19.38	25.51	6.19	15.46	20.90

※ The lifting force above does not include safety factor

Material Specifications

Material	Hardness Shore (°)	Color	Temperature (°C)
NBR	60	Black	-20~110
Silicone	55	Red	-70~200
White Silicone	55	Translucent White	-70~200
White Silicone (FDA)	55	Translucent White	-70~200
High temp. Silicone	50	Blue	-70~280
Conductive Silicone	70	Smoky Black	-45~90
Urethane	60	Dark Green	0~100
Mark Free	75	Black	-10~100
Polyurethane	60	Translucent Orange	0~60

Material Resistance

Description	NBR	Silicone	White Silicone	High temp. Silicone	Conductive Silicone	Urethane	Mark Free	Polyurethane
Wear Resistance	Excellent	Good	Good	Good	Good	Excellent	Good	Excellent
Oil	Excellent	Poor	Poor	Poor	Poor	Excellent	Excellent	Excellent
Weather / Ozone	Fair	Excellent	Excellent	Excellent	Excellent	Excellent	Excellent	Excellent
Alcohol	Good	Good	Good	Good	Good	Fair	Good	Fair
Acid	Fair	Poor	Poor	Poor	Poor	Poor	Excellent	Fair

Dimension

[Unit : mm]

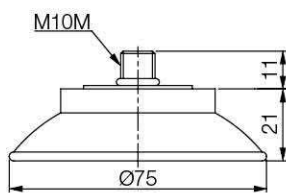

[With M10M fitting]

Build an Ordering No.

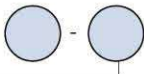
VFC75x1 -  : Pre-mounted fitting
 1. Suction Cup

1. Suction cup	Description	Weight(g)	Symbol
	Flat-Curved suction cup, 75mm diameter, Nitrile (NBR), M10xP1.5 Male Fitting	41.39	VFC75x1-N-M10M
	Flat-Curved suction cup, 75mm diameter, Silicone, M10xP1.5 Male Fitting	38.41	VFC75x1-S-M10M
	Flat-Curved suction cup, 75mm diameter, White silicone, M10xP1.5 Male Fitting	40.27	VFC75x1-WS-M10M
	Flat-Curved suction cup, 75mm diameter, White silicone (FDA), M10xP1.5 Male Fitting	40.27	VFC75x1-WS-M10M (FDA)
	Flat-Curved suction cup, 75mm diameter, High temperature silicone, M10xP1.5 Male Fitting	43.79	VFC75x1-HS-M10M
	Flat-Curved suction cup, 75mm diameter, Conductive silicone , M10xP1.5 Male Fitting	40.99	VFC75x1-CS-M10M
	Flat-Curved suction cup, 75mm diameter, Urethane, M10xP1.5 Male Fitting	41.24	VFC75x1-U-M10M
	Flat-Curved suction cup, 75mm diameter, Mark free, M10xP1.5 Male Fitting	47.13	VFC75x1-A-M10M
	Flat-Curved suction cup, 75mm diameter, Polyurethane, M10xP1.5 Male Fitting	38.22	VFC75x1-PU-M10M

SUCTION CUPS / Flat & Curve

VFC75x2



Features and Strengths

Specifically designed for flat and curved surface
Available to handle multiple objects with the same suction cup

Examples of use

Automobile Windscreens, Roof and Door, Metal Sheet
Shaped Metal panel, TV cathode ray tube



Recommended Lifting Force (Max.)

Model	Volume (cm ³)	Lifting Force (Kg) - Perpendicular			Lifting Force (Kg) - Parallel		
		- 20 kPa	- 60 kPa	- 90 kPa	- 20 kPa	- 60 kPa	- 90 kPa
VFC75x2	30.00	7.65	19.38	25.51	6.19	15.46	20.90

※ The lifting force above does not include safety factor

Material Specifications

Material	Hardness Shore (°)	Color	Temperature (°C)
NBR	60	Black	-20~110
Silicone	55	Red	-70~200
White Silicone	55	Translucent White	-70~200
White Silicone (FDA)	55	Translucent White	-70~200
High temp. Silicone	50	Blue	-70~280
Conductive Silicone	70	Smoky Black	-45~90
Urethane	60	Dark Green	0~100
Mark Free	75	Black	-10~100

Material Resistance

Description	NBR	Silicone	White Silicone	High temp. Silicone	Conductive Silicone	Urethane	Mark Free	Polyurethane
Wear Resistance	Excellent	Good	Good	Good	Good	Excellent	Good	Excellent
Oil	Excellent	Poor	Poor	Poor	Poor	Excellent	Excellent	Excellent
Weather / Ozone	Fair	Excellent	Excellent	Excellent	Excellent	Excellent	Excellent	Excellent
Alcohol	Good	Good	Good	Good	Good	Fair	Good	Fair
Acid	Fair	Poor	Poor	Poor	Poor	Poor	Excellent	Fair

Dimension

[Unit : mm]

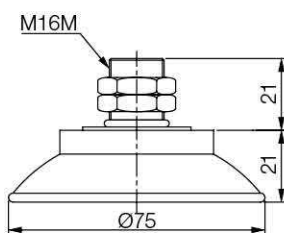

[With M16M fitting]

Build an Ordering No.

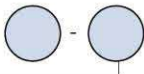
VFC75x2 -  : Pre-mounted fitting
 1. Suction Cup

1. Suction cup	Description	Weight(g)	Symbol
	Flat-Curved suction cup, 75mm diameter, Nitrile (NBR), M16xP1.0 Male Fitting	62.77	VFC75x2-N-M16M
	Flat-Curved suction cup, 75mm diameter, Silicone, M16xP1.0 Male Fitting	61.34	VFC75x2-S-M16M
	Flat-Curved suction cup, 75mm diameter, White silicone, M16xP1.0 Male Fitting	61.57	VFC75x2-WS-M16M
	Flat-Curved suction cup, 75mm diameter, White silicone (FDA), M16xP1.0 Male Fitting	61.57	VFC75x2-WS-M16M (FDA)
	Flat-Curved suction cup, 75mm diameter, High temperature silicone, M16xP1.0 Male Fitting	59.36	VFC75x2-HS-M16M
	Flat-Curved suction cup, 75mm diameter, Conductive silicone , M16xP1.0 Male Fitting	62.34	VFC75x2-CS-M16M
	Flat-Curved suction cup, 75mm diameter, Urethane, M16xP1.0 Male Fitting	63.76	VFC75x2-U-M16M
	Flat-Curved suction cup, 75mm diameter, Mark free, M16xP1.0 Male Fitting	68.96	VFC75x2-A-M16M

SUCTION CUPS / Flat & Curve

VFC90

Features and Strengths

Specifically designed for flat and curved surface
Available to handle multiple objects with the same suction cup

Examples of use

Automobile Windscreens, Roof and Door, Metal Sheet
Shaped Metal panel, TV cathode ray tube



Recommended Lifting Force (Max.)

Model	Volume (cm ³)	Lifting Force (Kg) - Perpendicular			Lifting Force (Kg) - Parallel		
		- 20 kPa	- 60 kPa	- 90 kPa	- 20 kPa	- 60 kPa	- 90 kPa
VFC90	60.00	9.80	24.82	32.65	9.52	21.59	27.89

※ The lifting force above does not include safety factor

Material Specifications

Material	Hardness Shore (°)	Color	Temperature (°C)
Polyurethane	60	Translucent Orange	0~60

Material Resistance

Description	Polyurethane
Wear Resistance	Excellent
Oil	Excellent
Weather / Ozone	Excellent
Alcohol	Fair
Acid	Fair

Dimension

[Unit : mm]

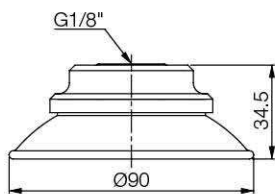

[With 18F fitting]

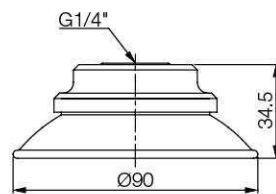

[With 14F fitting]

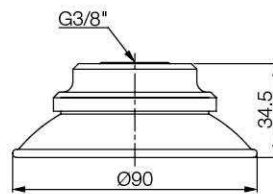

[With 38F fitting]

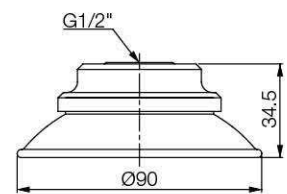

[With 12F fitting]

Build an Ordering No.

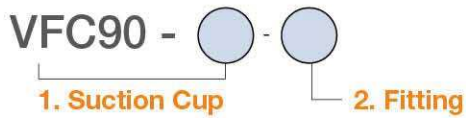

1. Suction cup	Description	Symbol
	Flat-Curved suction cup, 90mm diameter, Polyurethane	VFC90-PU
2. Fitting	Description	Symbol
	Fitting, G1/8 female	18F
	Fitting, G1/8 female, Mesh filter	M-18F
	Fitting, G1/4 female	14F
	Fitting, G1/4 female, Mesh filter	M-14F
	Fitting, G3/8 female	38F
	Fitting, G3/8 female, Mesh filter	M-38F
	Fitting, G1/2 female	12F
	Fitting, G1/2 female, Mesh filter	M-12F

Spare Parts – Rubber Parts

Part No.	Description	Weight (g)	Color
VFC90-PU	Flat-Curved suction cup, 90mm diameter, Polyurethane	62.19	Translucent Orange

Dimension

[Unit : mm]

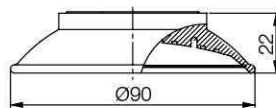

[Rubber part]

Spare Parts – Fittings

Part No. (Code No.)	Fitting size	Description	Weight (g)
350 000 3323	18F	G1/8 female	59.36
350 000 4323	18F-F	G1/8 female, Mesh filter	59.76
350 000 3423	14F	G1/4 female	56.92
350 000 3823	14F-F	G1/4 female, Mesh filter	57.32
350 000 3523	38F	G3/8 female	55.08
350 000 3923	38F-F	G3/8 female, Mesh filter	55.48
350 000 3623	12F	G1/2 female	51.50
350 000 4023	12F-F	G1/2 female, Mesh filter	51.9

SUCTION CUPS / Flat & Curve

VFC100



Features and Strengths

Specifically designed for flat and curved surface
Available to handle multiple objects with the same suction cup

Examples of use

Automobile Windscreens, Roof and Door, Metal Sheet
Shaped Metal panel, TV cathode ray tube



Recommended Lifting Force (Max.)

Model	Volume (cm ³)	Lifting Force (Kg) - Perpendicular			Lifting Force (Kg) - Parallel		
		- 20 kPa	- 60 kPa	- 90 kPa	- 20 kPa	- 60 kPa	- 90 kPa
VFC100	80.00	12.75	35.71	46.93	12.24	23.97	28.57

※ The lifting force above does not include safety factor

Material Specifications

Material	Hardness Shore (°)	Color	Temperature (°C)
NBR	60	Black	-20~110
Silicone	55	Red	-70~200
White Silicone	55	Translucent White	-70~200
White Silicone (FDA)	55	Translucent White	-70~200
High temp. Silicone	50	Blue	-70~280
Conductive Silicone	70	Smoky Black	-45~90
Urethane	60	Dark Green	0~100
Mark Free	75	Black	-10~100
Polyurethane	60	Translucent Orange	0~60

Material Resistance

Description	NBR	Silicone	White Silicone	High temp. Silicone	Conductive Silicone	Urethane	Mark Free	Polyurethane
Wear Resistance	Excellent	Good	Good	Good	Good	Excellent	Good	Excellent
Oil	Excellent	Poor	Poor	Poor	Poor	Excellent	Excellent	Excellent
Weather / Ozone	Fair	Excellent	Excellent	Excellent	Excellent	Excellent	Excellent	Excellent
Alcohol	Good	Good	Good	Good	Good	Fair	Good	Fair
Acid	Fair	Poor	Poor	Poor	Poor	Poor	Excellent	Fair

Dimension

[Unit : mm]

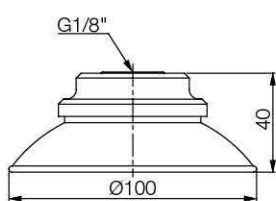

[With 18F fitting]

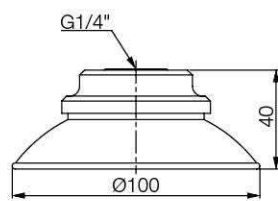

[With 14F fitting]

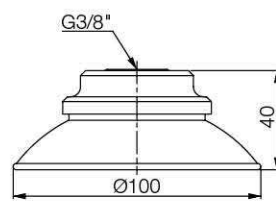

[With 38F fitting]

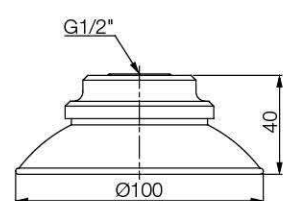

[With 12F fitting]

I Build an Ordering No.

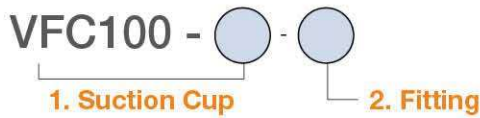

1. Suction cup	Description	Symbol
	Flat-Curved suction cup, 100mm diameter, Nitrile (NBR)	VFC100-N
	Flat-Curved suction cup, 100mm diameter, Silicone	VFC100-S
	Flat-Curved suction cup, 100mm diameter, White silicone	VFC100-WS
	Flat-Curved suction cup, 100mm diameter, White silicone (FDA)	VFC100-WS (FDA)
	Flat-Curved suction cup, 100mm diameter, High temperature silicone	VFC100-HS
	Flat-Curved suction cup, 100mm diameter, Conductive silicone	VFC100-CS
	Flat-Curved suction cup, 100mm diameter, Urethane	VFC100-U
	Flat-Curved suction cup, 100mm diameter, Mark free	VFC100-A
	Flat-Curved suction cup, 100mm diameter, Polyurethane	VFC100-PU

2. Fitting	Description	Symbol
	Fitting, G1/8 female	18F
	Fitting, G1/8 female, Mesh filter	M-18F
	Fitting, G1/4 female	14F
	Fitting, G1/4 female, Mesh filter	M-14F
	Fitting, G3/8 female	38F
	Fitting, G3/8 female, Mesh filter	M-38F
	Fitting, G1/2 female	12F
	Fitting, G1/2 female, Mesh filter	M-12F

I Spare Parts – Rubber Parts

Part No.	Description	Weight (g)	Color
VFC100-N	Flat-Curved suction cup, 100mm diameter, Nitrile (NBR)	83.87	Black
VFC100-S	Flat-Curved suction cup, 100mm diameter, Silicone	76.35	Red
VFC100-WS	Flat-Curved suction cup, 100mm diameter, White silicone	81.62	Translucent White
VFC100-WS (FDA)	Flat-Curved suction cup, 100mm diameter, White silicone (FDA)	81.62	Translucent White
VFC100-HS	Flat-Curved suction cup, 100mm diameter, High temperature silicone	88.74	Blue
VFC100-CS	Flat-Curved suction cup, 100mm diameter, Conductive silicone	80.32	Smoky Black
VFC100-U	Flat-Curved suction cup, 100mm diameter, Urethane	84.51	Dark Green
VFC100-A	Flat-Curved suction cup, 100mm diameter, Mark free	95.71	Black
VFC100-PU	Flat-Curved suction cup, 100mm diameter, Polyurethane	70.74	Translucent Orange

I Dimension

[Unit : mm]

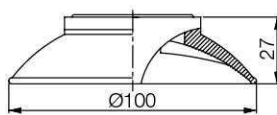

[Rubber part]

I Spare Parts – Fittings

Part No. (Code No.)	Fitting size	Description	Weight (g)
350 000 3323	18F	G1/8 female	59.36
350 000 4323	18F-F	G1/8 female, Mesh filter	59.76
350 000 3423	14F	G1/4 female	56.92
350 000 3823	14F-F	G1/4 female, Mesh filter	57.32
350 000 3523	38F	G3/8 female	55.08
350 000 3923	38F-F	G3/8 female, Mesh filter	55.48
350 000 3623	12F	G1/2 female	51.50
350 000 4023	12F-F	G1/2 female, Mesh filter	51.9